

Bank of China, Sydney

Case Study

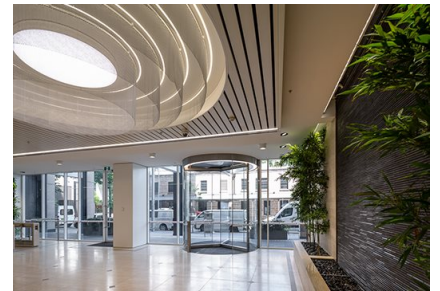

Looking to expand its Australian operations, Bank of China in 2016 acquired 140 Sussex Street, a 14 storey A grade office tower with views of Sydney's Darling Harbour. Before relocating its Australian head office to this site, an extensive lobby refurbishment was undertaken by Built and designed by Group GSA architects.

For the main entrance a 3000mm diameter record Hybrid Series revolving door, in a finished stainless steel finish, was selected with a height of 3465mm to ensure the door canopy sits directly below the internal ceiling finishes.

Instead of standard LED downlights in the centre rotating ceiling, this revolving door features record's unique halo lighting feature, with the canopy structure modified to accommodate this lighting around the full perimeter of the door.

To provide additional free egress in an emergency this revolving door is fitted with an automatic wind back door wing, with fire trip connectivity and battery backup for operation in a power failure.

In addition to the revolving door record also provided a DFA 127 automatic operator for the adjacent DDA compliant swing door, as well as disabled toilets in the upper levels, along with STA 20 sliding door operators to some of the lift lobby entries.

Bank of China, Sydney

Case Study



Bank of China, Sydney

Case Study



Bank of China, Sydney

Case Study



Bank of China, Sydney

Case Study



Bank of China, Sydney

Case Study

