

# Rail Operations Centre

## Case Study

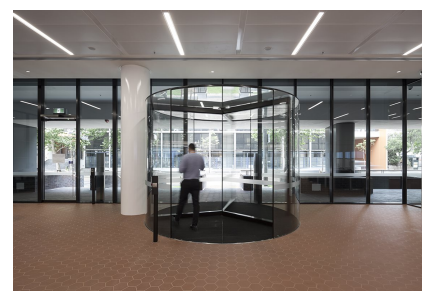
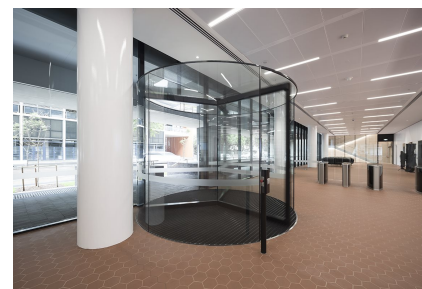

The Rail Operations Centre in Alexandria is a NSW Government Initiative, designed by Smart Design Studio in collaboration with Jacobs and delivered by AW Edwards, to modernise and centralise the management of the Sydney train network in an effort to minimise delays and improve information flow. The state-of-the-art control centre is housed in a four storey architecturally designed red brick building with striking arches that symbolically reflect historical railway bridges and the industrial heritage of the Alexandria area.

For the main lobby entrance, setback from this brick façade, a record Diamond Series revolving door was installed with its full frameless glass design and recessed position within the glazing line allowing the door to provide the necessary energy efficiency benefits of an airlocked entrance, without detracting from the bold design theme of the surrounding finishes.

The revolving door has cladding trims in charcoal pearl powdercoat aluminium to match the surrounding mullion framing and a floor mat in black matting and aluminium framing, removable to provide access to the drive system mounted within a floor pit formed in the concrete slab.

Being a NSW Government project, record Automatic Doors was proud to be able provide a revolving door manufactured in the local area at its Seven Hills factory.

# Rail Operations Centre

## Case Study





# Rail Operations Centre

## Case Study





# Rail Operations Centre

## Case Study

